

## Composite insulators

### CS-110/120 CT

Type

- CS Composite insulator
- DE Dead End insulator
- SU Suspension / Tension insulator
- SSP Station Post insulator
- HFB Hollow insulator

Rated voltage -kV

10 - 700 kV

Specified Mechanical Load (SML)

40 - 600 SML (kN)

Right End Coupling

- B Ball
- S Socket
- T Tongue
- C Clevis
- Y Y-fitting
- E Eye

Left End Coupling

- B Ball
- S Socket
- T Tongue
- C Clevis
- Y Y-Fitting
- E Eye

**Special variants:** If you need a special variant of insulators, please do not hesitate to contact us. Maybe the type of Insulator you are looking for is among our many special designs. If not, we can also supply customized designs. In this case, however, minimum order quantities apply

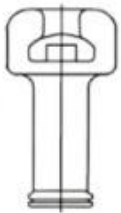

Socket



Ball



Tongue

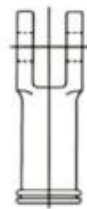

Clevis



Eye



Y Fitting

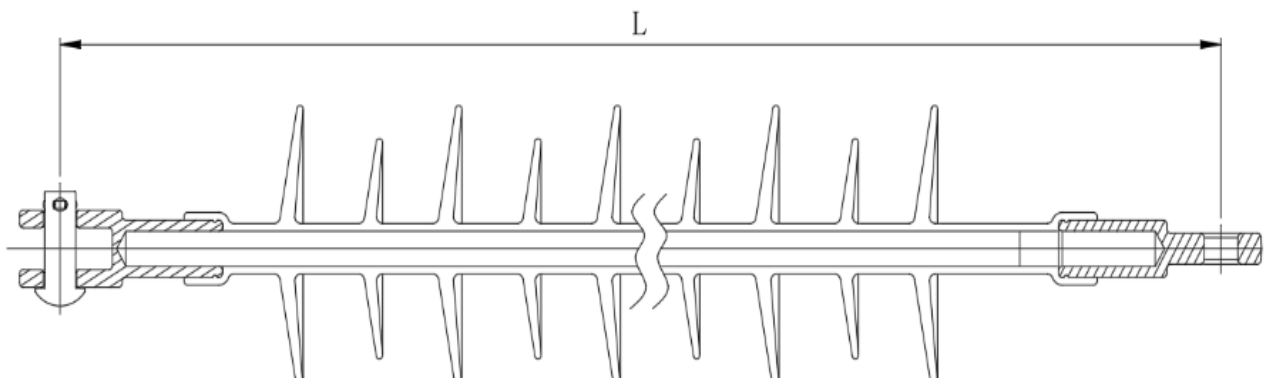

Example

## Composite insulators - Dead End Insulators

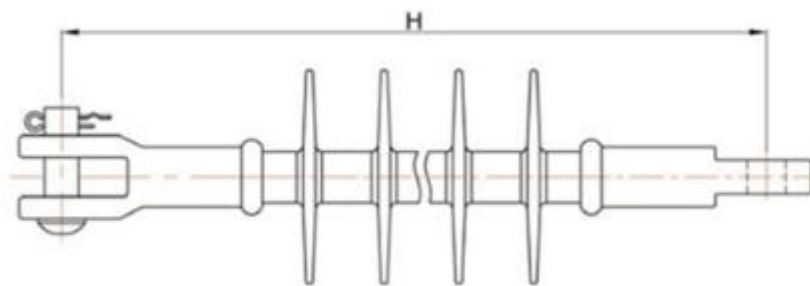

Product number	Section Length (H) mm	Creepage distance mm	LF Flashover Dry kV	LF Flashover Wet kV	Critical Impulse Flashover + kV	RIV test voltage kV	Max RIV at 1MHz $\mu$ V	Specified Mechanical Load LB
DE-15/70	330 $\pm$ 15	355	90	65	140	15	10	15000
DE-28/70	430 $\pm$ 15	550	130	100	190	20	10	15000
DE-35/70	525 $\pm$ 15	730	145	130	250	30	10	15000
DE-46/70	590 $\pm$ 15	900	180	145	280	30	10	15000
DE-69/70	750 $\pm$ 15	1190	220	185	360	45	10	15000

## Composite insulators - Suspension / Tension Insulators — 66 kV

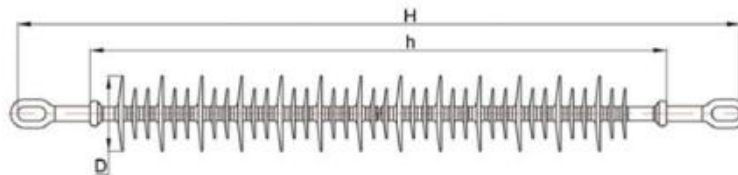
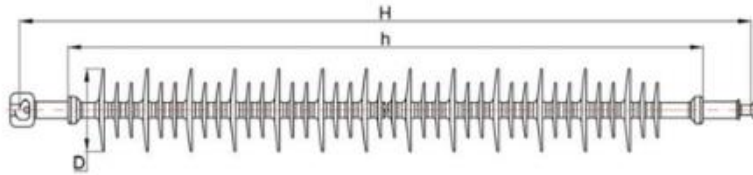

Product number	Fig. No	Rated Voltage kV	Creepage distance mm	Section Length H(mm)	Lightning Impulse Withstand kV	Power Freq. Withstand kV	Specified Mechanical Load kN
SU-66/70-870	2.1.1	66	2000	870 ± 15	410	185	70
SU-66/70-870	2.1.2	66	1920	870 ± 15	410	185	70
SU-66/70-940		66	2200	940 ± 15	410	185	70
SU-66/100-870		66	2000	870 ± 15	410	185	100
SU-66/100-870		66	1920	870 ± 15	410	185	100
SU-66/100-940		66	2200	940 ± 15	410	185	100
SU-66/120-870		66	1920	870 ± 15	410	185	120
SU-66/120-870		66	2000	870 ± 15	410	185	120
SU-66/120-940		66	2200	940 ± 15	410	185	120
SU-66/120-1066		66	2800	1066 ± 15	410	185	120

## Composite insulators - Tension Insulators — 110 / 220 kV

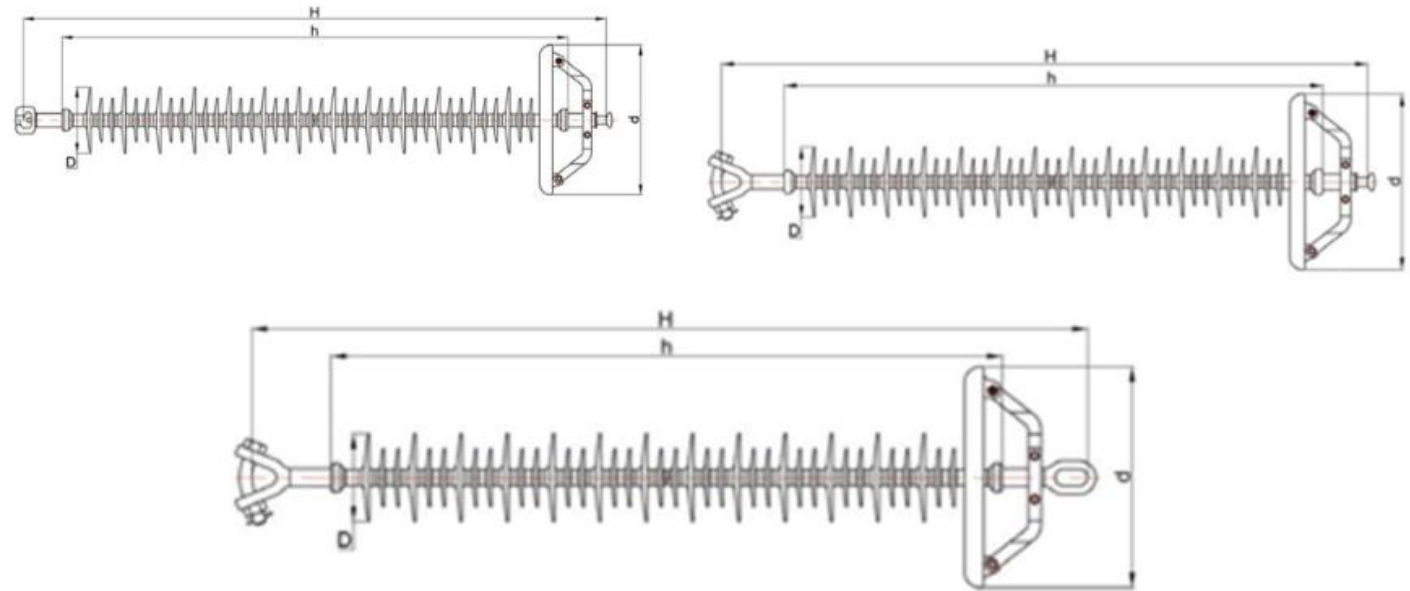

Product number	Rated Voltage kV	Section Length H(mm)	Creepage Distance mm	Lightning Impulse Withstand kV	1 Min Wet Power Freq. Withstand kV	Specified Mechanical Load kN
SU-110/70	110	1240±15	3300	550	230	70
SU-110/100	110	1240±15	3300	550	230	100
SU-110/100	110	1380±15	3700	550	230	100
SU-110/160	110	1380±15	3700	550	230	160
SU-132/70	132	1480±15	3900	660	275	70
SU-132/100	132	1480±15	3900	660	275	100
SU-132/100	132	1480±15	4100	660	275	100
SU-132/160	132	1480±15	4100	660	275	160
SU-220/100	220	2240±30	6800	1000	395	100
SU-220/120	220	2340±30	6800	1000	395	120
SU-220/160	220	2340±30	6800	1000	395	160
SU-220/180	220	2340±30	6800	1000	395	180
SU-220/210	220	2340±30	6800	1000	395	210

## Composite insulators - Station Post Insulators

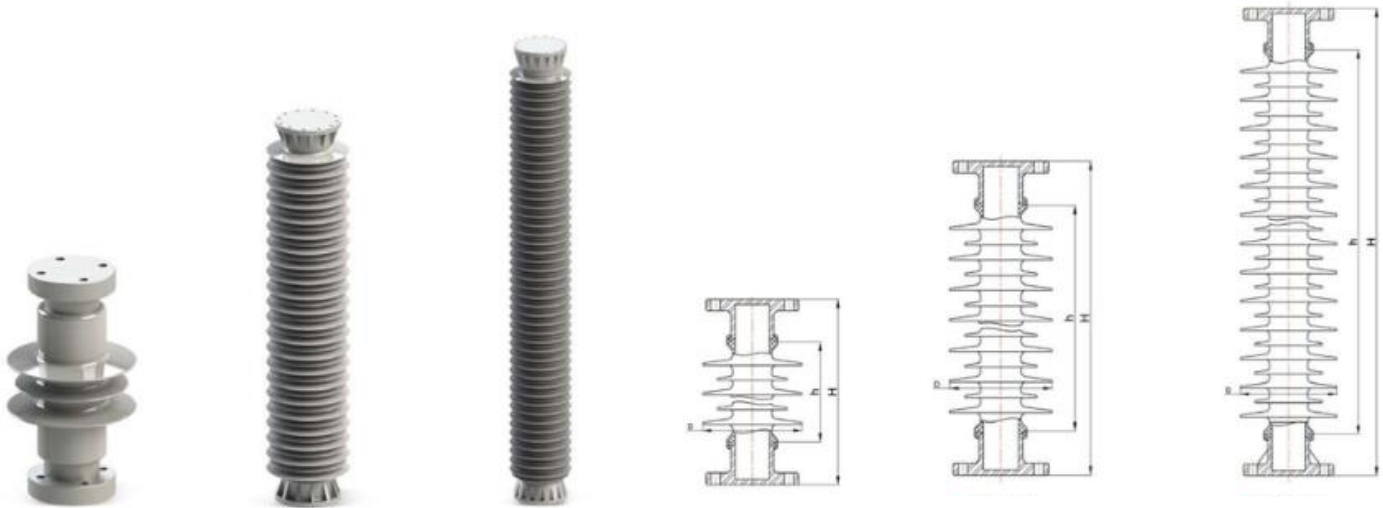

Product number	Fig No.	Rated Voltage kV	Specified Cantilever Load kN	Section Length H(mm)	Creepage Distance mm	Lightning Impulse Withstand kV	1 Min Wet Power Freq. Withstand kV
SSP-10/6	4.1	10	6	215 ± 1	380	95	38
SSP-10/8		10	8	215 ± 1	380	95	38
SSP-20/6		20	6	305 ± 1	680	125	50
SSP-20/8		20	8	305 ± 1	680	125	50
SSP-20/10		20	10	355 ± 1	720	150	50
SSP-35/4	4.2	35	4	560 ± 1	1320	250	95
SSP-35/8		35	8	560 ± 1	1320	250	95
SSP-66/4		66	4	770 ± 1	2160	325	140
SSP-66/8	4.3	66	8	770 ± 1	2160	325	140
SSP-132/4.5		132	4,5	1500 ± 2	4500	650	275
SSP-126/8		110	8	1300 ± 2	3300	550	230
SSP-126/10		110	10	1220 ± 1	3300	550	460
SSP-126/12.5		110	12,5	1220 ± 1	3300	550	460
SSP-252/4		252	4	2300 ± 3.5	6300	1050	460

## Composite insulators - Hollow Insulators



Product number	Rated voltage kV	Height mm	Creepage mm	MML kN·m	SML kN·m	Routine inner pressure MPa	Specified inner pressure MPa
HFB-40.5/20	40.5	600	1499	8	20	0,8	3,2
HFB-40.5/30	40.5	600	1256	12	30	0,8	3,2
HFB-72.5/11	72.5	820	1813	3,5	8,8	1	4
HFB-72.5/31	72.5	800	2248	10	25	0,8	3,2
HFB-126/15	126	1350	4158	10,5	15	0,8	1,6
HFB-126/25	126	1306	3150	12,5	25	1,5	6
HFB-126/15	126	1315	4410	6	15	0,8	3,2
HFB-126/20	126	1330	3906	10	20	0,7	2,6
HFB-126/16.5	126	1480	2520	6,5	16,5	1	4
HFB-126/20	126	1320	3906	8	20	1	4
HFB-126/12.5	126	1400	3906	5	12,5	1	4
HFB-126/25	126	1360	3906	10	25	1	4
HFB-126/25	126	1200	3906	10	25	1	4
HFB-145/12.5	145	1500	4495	5	12,5	1	4
HFB-145/20	145	1500	4495	8	20	1	4
HFB-145/25	145	1500	4495	10	25	1	4
HFB-145/22.5	145	1700	5800	9	22,5	1	4
HFB-145/20	145	1840	5655	10	20	1	4
HFB-170/12.5	170	1732	5270	5	12,5	0,8	3,2
HFB-170/22.5	170	1995	5950	9	22,5	1	4
HFB-252/55	245/252	2400	7595/7812	22	55	1	4
HFB-252/45	245/252	2260	7595/7812	18	45	1	4
HFB-252/85	245/252	2336	7595/7812	34	85	0,8	3,2
HFB-252/10	245/252	2206	5635/5796	4	10	1	4